

# Emergency Lighting

COMPLETE EMERGENCY  
LIGHTING SOLUTIONS



The CQR Emergency Lighting solution provides a comprehensive range of products for all your applications, supported by a full lighting design to ensure compliance and maximise safety for your project site.

### 1. BULKHEADS

- 150lm & 1000/1500lm
- Maintained and Non-Maintained
- IP65 & IP66 Options

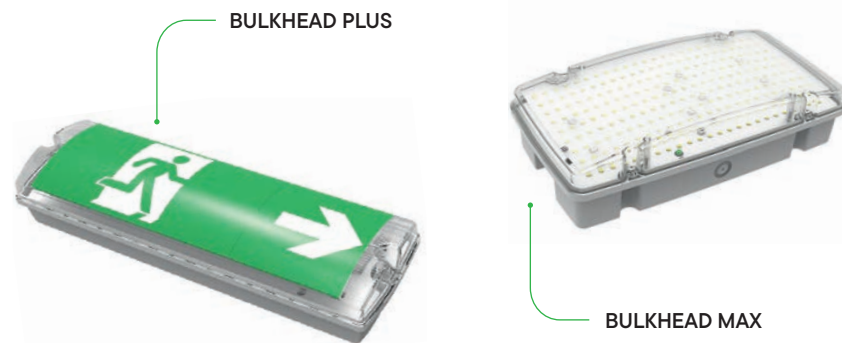

### 2. DOWNLIGHTS: RECESSED & SURFACE

- 120/130lm & 230/270lm
- Surfaced & Recessed
- Black & White Fittings



### 3. EXIT BOXES



SLIM EXIT BOX

- Self-test Versions Available
- Optional Legends & Brackets
- Available in Black & White Fittings

### 4. EXIT SIGNS



BLADE

## EMERGENCY LIGHTING SOLUTIONS

### 5. TWIN SPOTS

- Standard & High Output
- Black & White Fittings
- IP65 & Self-test Options

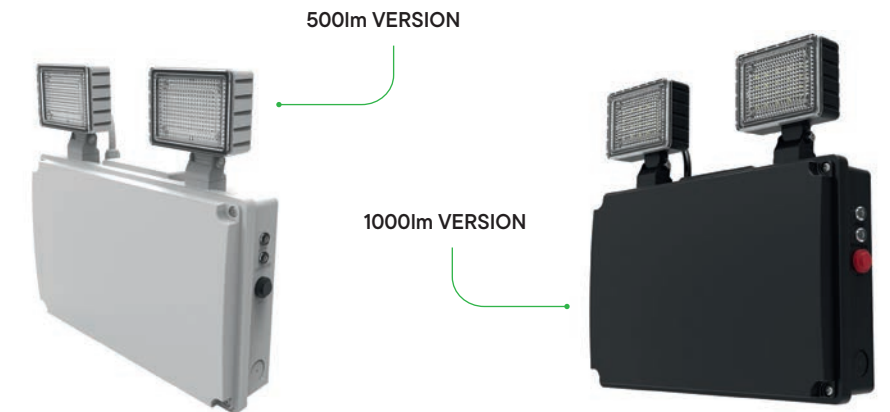

### PRODUCT TECHNOLOGY

**LiFeP04**

Lithium Ion LiFeP04 battery technology in all of our products. CQR Lithium Ion Phosphate provides double the effective battery life of standard batteries.

### PRODUCT WARRANTY



Comprehensive 5 year warranty for the full product, including battery on all CQR Emergency Lighting Products.

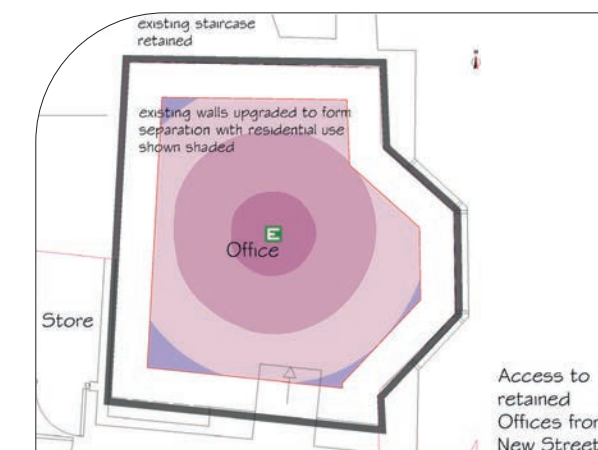

### DESIGN SOLUTION

Free lighting design service for customers purchasing from a CQR approved stockist.

Email: [lightingdesign@cqr.co.uk](mailto:lightingdesign@cqr.co.uk)

Send your project requirements to our lighting design team for further details.



UNDERSTANDING EMERGENCY LIGHTING

MAINTAINED v NON-MAINTAINED:  
WHAT IS THE DIFFERENCE?

Non-Maintained Emergency luminaires only operate during a power outage, where once activated the luminaires use their 3 hours of charged battery back up to provide adequate levels of light for the site's inhabitants to exit safely.

Maintained Emergency luminaires remain permanently on with a constant supply to ensure the battery is charged whilst the LED also remains illuminated at all times. This is commonly found in places of public assembly such as cinemas, leisure centres and other areas of public gathering.



LED Colour	Status	On Time (Seconds)	Off Time (Seconds)	Description
Green	Permanent on	/	/	Normal status when mains connected
	Slow flash	1s	1s	Duration test running
	Fast flash	0.2s	0.2s	Function test running
	Normal flash three times only	0.5s	0.5s	Time reset
Red	Permanent on	/	/	Battery failure
	Slow flash	1s	1s	Lamp failure
	Fast flash	0.2s	0.2s	Duration failure - the capacity of the battery is not enough
Both Off	Off	/	/	Emergency mode

MANUAL TEST v SELF-TEST : WHAT IS THE BENEFIT?

Manual test luminaires can only be tested by removing power, waiting 3 hours and visually checking to see if the emergency lighting is still on. This manual process takes significant time and labour to check.

Self-test units perform their own tests to an internal timer, negating the need for manual testing. It is important however to visually inspect the self-test luminaires to see if they contain any error codes as per the referenced table to the side of this paragraph for our Bulkhead Plus Self-test model.

SPACING TABLES: WHAT IS THEIR PURPOSE?

CQR Emergency Luminaires are provided with spacing tables on our product data sheets or by following the QR code link on each product page of this catalogue. Spacing tables are used as quick reference guides for specifiers, without needing to run a full lighting design. The tables will allow the user to tell how far apart luminaires can be spaced whilst maintaining a minimum lux level. Full computer software generated lighting designs provide a more comprehensive solution however to spacing tables for larger projects.

Spacing tables display a range of icons on the top line illustrating the different possible relationship between the luminaires and surroundings. The relationship to other luminaires, orientations, mounting height and surroundings significantly effects the lux level achieved at each point. The words 'transverse' and 'axial' simply tell you which way the luminaires are orientated. For the circular luminaires, they tell you which way the 'photometry' is orientated. Please see the below illustration of axial and transverse in relation to our emergency luminaire types:

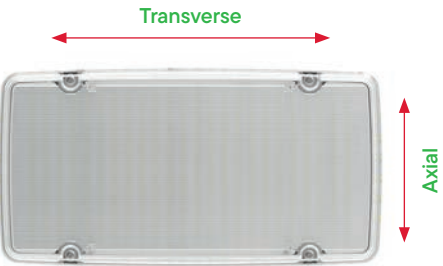

BULKHEAD MAX

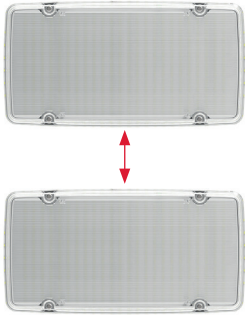

TRANSVERSE TO TRANSVERSE

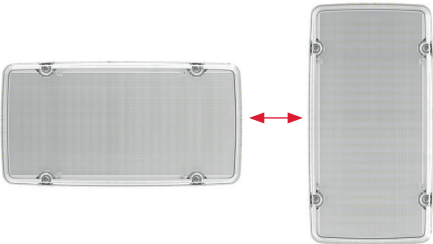

AXIAL TO TRANSVERSE

Spacing Data (1 lux)

Mounting Height (m)					
2.50	1.57	4.77	6.74	8.92	3.64
3.00	1.32	4.55	6.94	9.57	3.49

SPACING TABLES  
TYPICALLY LOOK LIKE THE  
FOLLOWING FORMAT:

UNDERSTANDING EMERGENCY LIGHTING

EMERGENCY LIGHTING CLASSIFICATIONS: WHAT ARE THEY?

In accordance with EN 60598-2-22 emergency luminaires are to be classified and marked according to their function and construction. On all Emergency luminaires a sticker is now visible with four squares as detailed below:

EMERGENCY LIGHTING CLSSIFICATION:

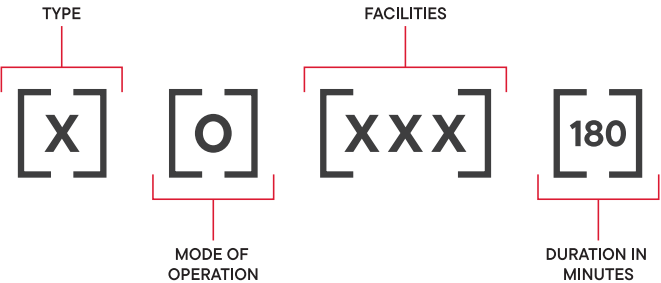

CQR CLASSIFICATION LABEL ON OUR  
EMERGENCY LUMINARIES:

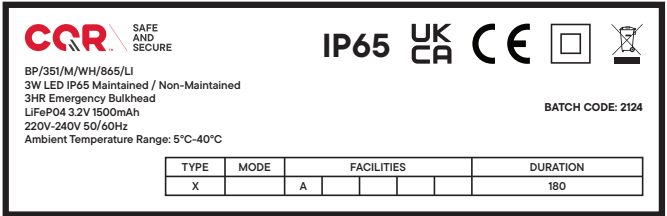

1. TYPE

- X Self-Contained
- Y Central Battery

2. MODE OF OPERATION

- 0 Non-Maintained
- 1 Maintained
- 2 Combined Non-Maintained
- 3 Combined Maintained
- 4 Compound Non-Maintained
- 5 Compound Maintained
- 6 Satellite

3. FACILITIES

- A Including test device
- B Including remote test device
- C Including inhibiting mode
- D High risk task luminaire
- E Non-replaceable lamps or battery
- F Automatic test gear
- G Internally illuminated safety sign

4. DURATION IN MINUTES

10, 60, 120 or 180

LIGHTING DESIGN :  
WHY SHOULD YOU  
REQUEST A DESIGN?

CQR provides a complimentary Emergency Lighting design service for our stockist dealers, providing our customers with the full design plans and photometric data for added installer confidence and project support. CQR Emergency lighting designs will also show you the most efficient way to provide a compliant system utilising our wide range of luminaires to ensure the best product for the application requirements.

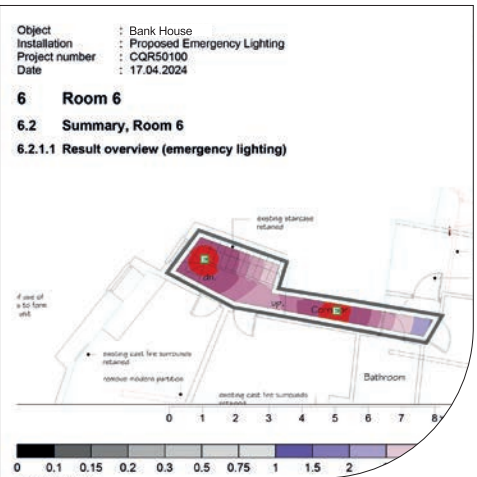
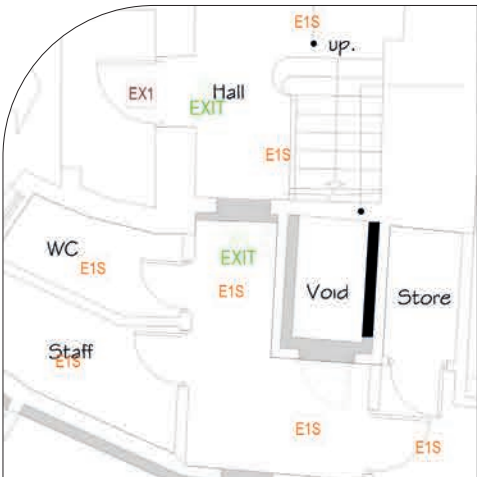



07 EMERGENCY BULKHEADS

- 08 Bulkhead Plus
- 09 Bulkhead Max

10 EMERGENCY DOWNLIGHTS

- 11 Spot Non-Maintained Recessed
- 12 Escape Square - Surface Mount
- 13 Escape Round - Surface Mount

14 EMERGENCY EXIT BOXES & EXIT SIGNS

- 15 Exit Box Slimline
- 16-17 Blade 5 in 1

18 EMERGENCY TWIN SPOTS

- 19 500lm & 1000lm Versions

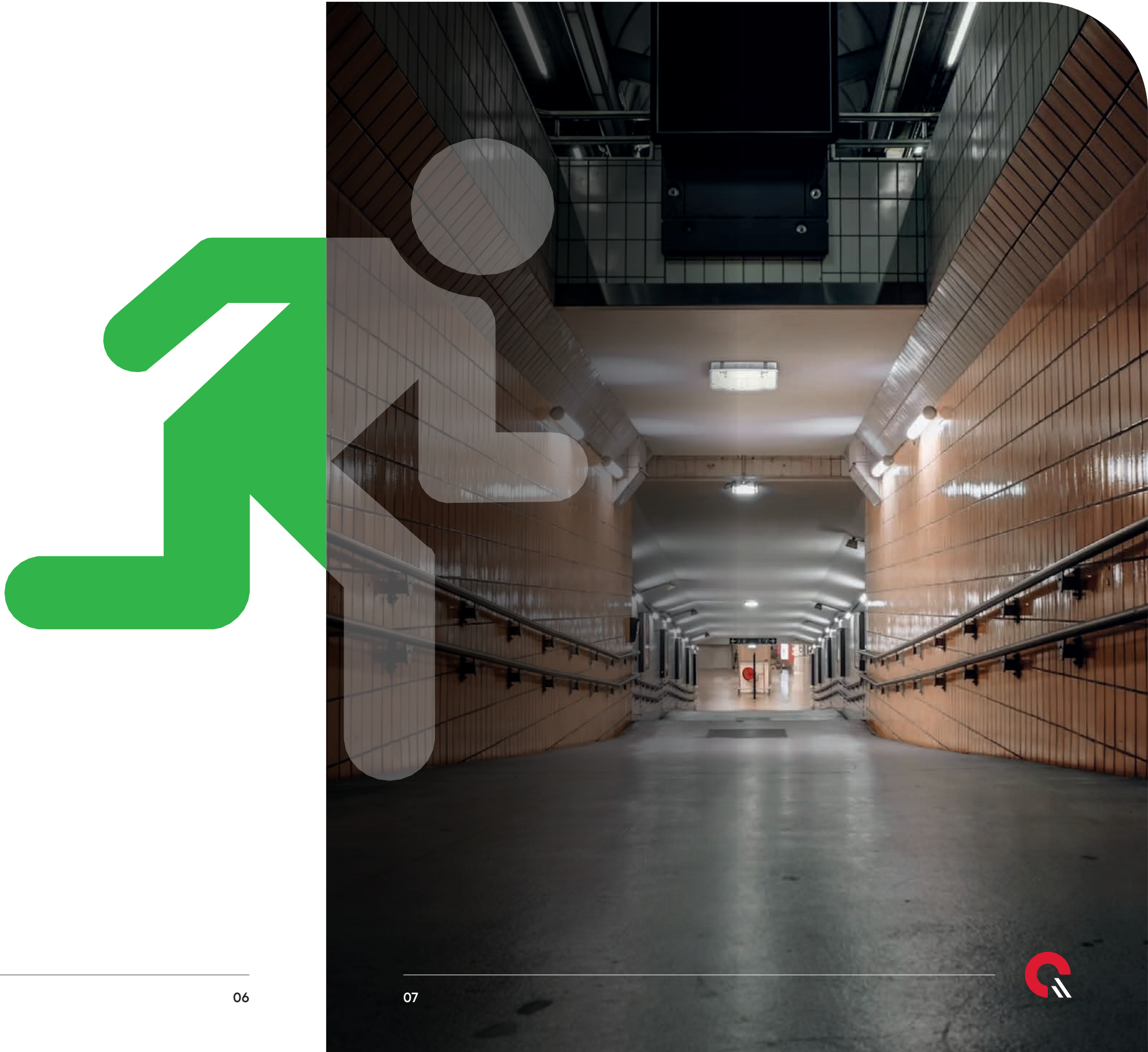

EMERGENCY BULKHEADS - Bulkhead Plus



Scan the QR code to see the product spacing data

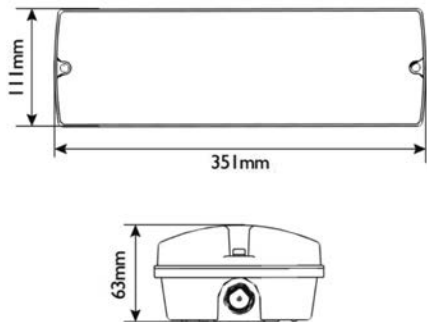

PRODUCT DESCRIPTION

- Class II, IP65, 3 hours emergency bulkhead
- Hinged gear tray with push fit terminals
- Maintained & non-maintained optionality as standard
- Installation – surface or recessed by mounting kit
- Manual test and Self-test options available
- Exit sign diffuser available to order
- 5 years warranty: full fitting and battery

OPTIONAL EXIT SIGN DIFFUSER  
AND LEGEND KIT  
BP/EXITKIT



OPTIONAL RECESS KIT  
BP/RECESSKIT



PRODUCT SPECIFICATION

VOLTAGE	AC 220-240V
INPUT POWER	3.2W (Charging Mode) 1W (Emergency Mode)
LUMEN OUTPUT (MAINS)	150lm
LUMEN OUTPUT (EMERGENCY)	175lm
EMERGENCY DURATION	3 Hours
EMERGENCY POWER	1W
COLOUR TEMP	6500K
BEAM ANGLE	120°
RATED LIFE	L80 50,000hrs
IP RATING	IP65
MATERIAL	Polycarbonate
WARRANTY	5 Years: full fitting and battery

PRODUCT CODE	PRODUCT DESCRIPTION
BP/351/M/WH/865/LI	CQR LED Emergency Bulkhead Plus, 3W, Maintained, IP65, LiFeP04
BP/351/ST/WH/865	CQR LED Emergency Bulkhead Plus, SELF-TEST - 3W, Maintained, IP65, LiFeP04

ACCESSORY CODE	PRODUCT DESCRIPTION
BATTERY/18650/1500	CQR Replacement Battery Bulkhead Plus / Spot Downlight / Exit Box Slimline

EMERGENCY BULKHEADS - Bulkhead Max



Scan the QR code to see the product spacing data

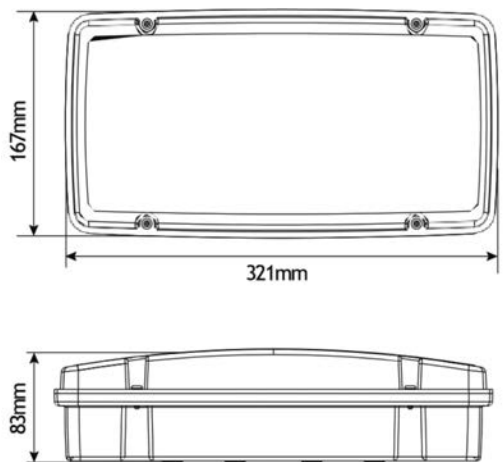
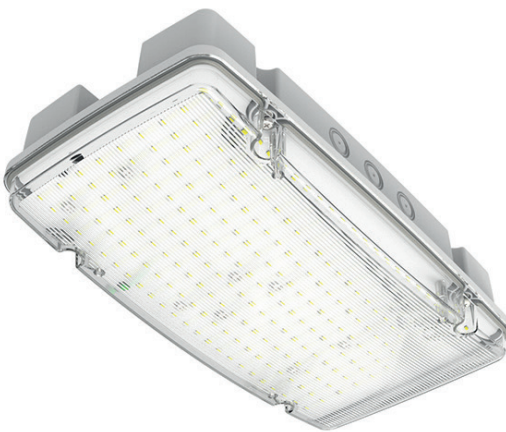

PRODUCT DESCRIPTION

- High Output Emergency Bulkhead: 1000/1500lm
- IP66: Ideal for high installations such as plant rooms or lift shafts
- Integrated gear tray into diffuser for easy install
- Non-maintained with self test options available
- Manual test and Self-test options available
- Emergency power: 6W/10W & 1000/1500lm
- 5 years warranty: full fitting and battery



PRODUCT SPECIFICATION

VOLTAGE	AC 220-240V
INPUT POWER	4.5W (Charge mode) 6.6W@1000lm (Emergency mode) 10W@1500lm (Emergency mode)
LUMEN OUTPUT (MAINS)	1000lm / 1500lm selectable
LUMEN OUTPUT (EMERGENCY)	1083lm / 1587lm
EMERGENCY DURATION	3 Hours
EMERGENCY POWER	6W / 10W
COLOUR TEMP	6500K
BEAM ANGLE	135°
RATED LIFE	L70 50,000hrs
IP RATING	IP66
MATERIAL	Polycarbonate
WARRANTY	5 Years: full fitting and battery

PRODUCT CODE	PRODUCT DESCRIPTION
BM/10/NM/WH/865	CQR LED Emergency Bulkhead MAX High Output, Non -Maintained, 1500lm, IP65-White
BM/10/ST/WH/865	CQR LED Emergency Bulkhead MAX High Output, SELF-TEST, 1500lm, IP65-White

ACCESSORY CODE	PRODUCT DESCRIPTION
BATTERY/26650/6600	CQR Replacement Battery Bulkhead Max / Twin Spots 2 x 500lm





# Emergency Downlights



## EMERGENCY DOWNLIGHTS - Spot Non-Maintained Recessed



Scan the QR code to see the product spacing data

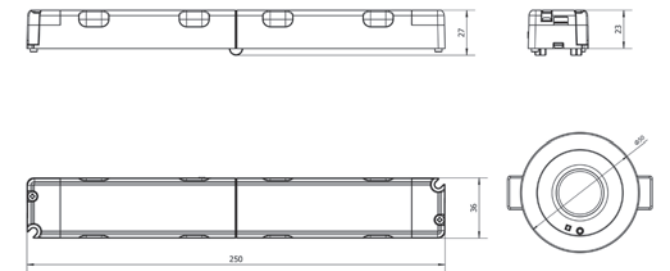

### PRODUCT DESCRIPTION

- Emergency Downlight Spot: Recessed
- Supplied with Open Area Lens (120lm) and Corridor Lens (130lm) as standard
- Foldable converter: easy to install
- Non-maintained fitting
- 5 years warranty: full fitting and battery
- Available in black and white
- Self-test functions available

OPEN AREA LENS  
120lm



CORRIDOR LENS  
130lm



BLACK EMERGENCY DOWNLIGHT  
SP/1/NM/BK/865

### PRODUCT SPECIFICATION

VOLTAGE	AC 220-240V
INPUT POWER	12W (Charging power) / 0.4W (Charging power when battery full) / 1W (Emergency mode)
LUMEN OUTPUT (EMERGENCY)	Open Area Lens: 120lm and Corridor Lens: 130lm
EMERGENCY DURATION	3 Hours
EMERGENCY POWER	1W
COLOUR TEMP	6500K
BEAM ANGLE	165° (Open area) / 160° x 50° (Corridor)
RATED LIFE	L80 50,000hrs
IP RATING	IP20
MATERIAL	Polycarbonate
WARRANTY	5 Years: full fitting and battery

PRODUCT CODE	PRODUCT DESCRIPTION
SP/1/NM/WH/865	CQR LED Emergency Downlight Spot c/w Open Area & Corridor Lens - White
SP/1/NM/BK/865	CQR LED Emergency Downlight Spot c/w Open Area & Corridor Lens - Black
SP/1/ST/WH/865	CQR LED Emergency Downlight Spot - SELF-TEST - c/w Open Area & Corridor Lens - White

ACCESSORY CODE	PRODUCT DESCRIPTION
BATTERY/18650/1500	CQR Replacement Battery Bulkhead Plus / Spot Downlight / Exit Box Slimline



EMERGENCY DOWNLIGHTS - Escape Square - Surface Mount



Scan the QR code to see the product spacing data

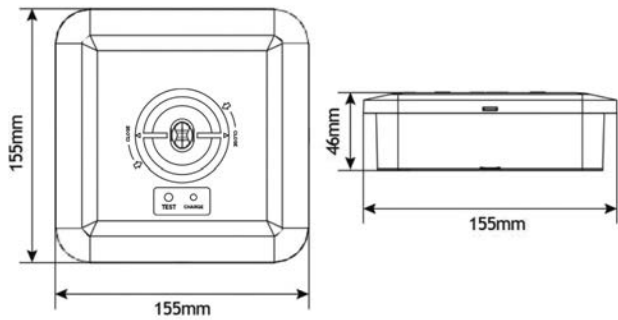

PRODUCT DESCRIPTION

- Emergency Downlight: Surface Mount Escape Square
- Supplied with Open Area Lens (270lm) & Corridor Lens (230lm)
- IP65 rated
- 5 years warranty: full fitting and battery
- Available in black and white
- Self-test functions available
- 20mm conduit entry points
- Ideal for restaurants & large open areas

OPEN AREA LENS  
270lm



CORRIDOR LENS  
230lm



BLACK ESCAPE SQUARE  
ES/2/NM/BK/865



PRODUCT SPECIFICATION

VOLTAGE	AC 220-240V
INPUT POWER	2W (Charging power) / 2W (Emergency mode)
LUMEN OUTPUT (EMERGENCY)	Open Area Lens: 270lm and Corridor Lens: 230lm
EMERGENCY DURATION	3 Hours
EMERGENCY POWER	2W
COLOUR TEMP	6500K
BEAM ANGLE	Open area - 150°/ Corridor - 80° x 30°
RATED LIFE	L80 50,000hrs
IP RATING	IP65
MATERIAL	Polycarbonate
WARRANTY	5 Years: full fitting and battery

PRODUCT CODE	PRODUCT DESCRIPTION
ES/2/NM/WH/865	CQR LED Emergency Escape Square Surface Downlight c/w 2 Lens, IP65 - White
ES/2/NM/BK/865	CQR LED Emergency Escape Square Surface Downlight c/w 2 Lens, IP65 - Black
ES/2/ST/WH/865	CQR LED Emergency Escape Square Surface Downlight - SELF-TEST - c/w 2 Lens, IP65 - White

ACCESSORY CODE	PRODUCT DESCRIPTION
BATTERY/18650/3300	CQR Replacement Battery Escape Square & Round

EMERGENCY DOWNLIGHTS - Escape Round - Surface Mount



Scan the QR code to see the product spacing data

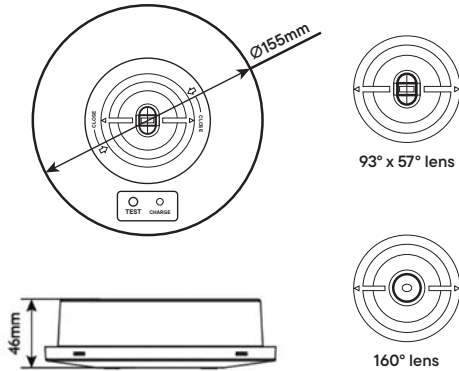

PRODUCT DESCRIPTION

- Emergency Downlight: Surface Mount Escape Round
- Supplied with Open Area Lens (270lm) & Corridor Lens (230lm)
- IP65 rated
- 5 years warranty: full fitting and battery
- Available in black and white
- Self-test functions available
- 20mm conduit entry points
- Ideal for restaurants & large open areas

OPEN AREA LENS  
270lm



CORRIDOR LENS  
230lm



BLACK ESCAPE ROUND  
ER/2/NM/BK/865



PRODUCT SPECIFICATION

VOLTAGE	AC 220-240V
INPUT POWER	2W (Charging power) / 2W (Emergency mode)
LUMEN OUTPUT (EMERGENCY)	Open Area Lens: 270lm and Corridor Lens: 230lm
EMERGENCY DURATION	3 Hours
EMERGENCY POWER	2W
COLOUR TEMP	6500K
BEAM ANGLE	Open area - 150°/ Corridor - 80° x 30°
RATED LIFE	L80 50,000hrs
IP RATING	IP65
MATERIAL	Polycarbonate
WARRANTY	5 Years: full fitting and battery

PRODUCT CODE	PRODUCT DESCRIPTION
ER/2/NM/WH/865	CQR LED Emergency Escape Round Surface Downlight c/w 2 Lens, IP65 - White
ER/2/NM/BK/865	CQR LED Emergency Escape Round Surface Downlight c/w 2 Lens, IP65 - Black
ER/2/ST/WH/865	CQR LED Emergency Escape Round Surface Downlight - SELF-TEST - c/w 2 Lens, IP65 - White

ACCESSORY CODE	PRODUCT DESCRIPTION
BATTERY/18650/3300	CQR Replacement Battery Escape Square & Round





# Emergency Exit Boxes & Exit Signs



## EMERGENCY EXIT BOXES - Slimline

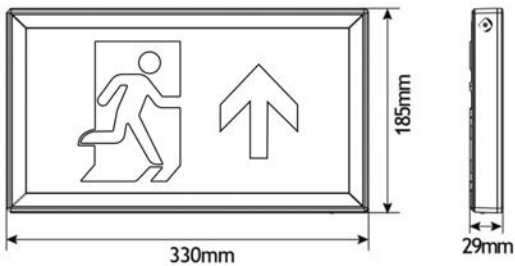

### PRODUCT DESCRIPTION

- Emergency slim exit box
- Includes arrow up legend
- Other legends available separately
- 30 metre viewing distance
- Angle adjustable downlight
- Maintained & Non-maintained optionality as standard
- Self-test function available
- Available in white and black

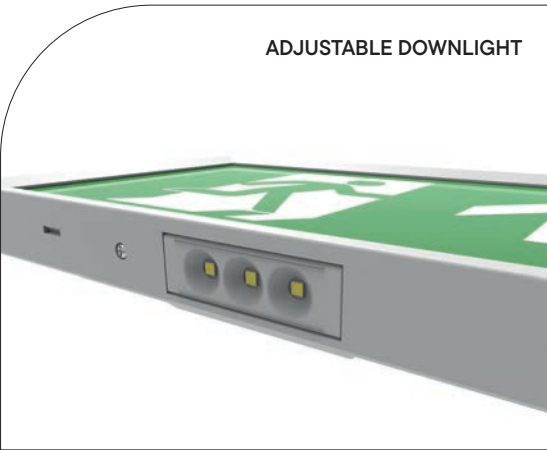

BLACK SLIMLINE EXIT BOX  
SE/4/M/BK/865



### PRODUCT SPECIFICATION

VOLTAGE	AC 220-240V
INPUT POWER	<4W
LUMEN OUTPUT (EMERGENCY)	10lm (legend) 80lm (downward light)
VIEWING DISTANCE	30M
EMERGENCY DURATION	3 Hours
EMERGENCY POWER	1W
COLOUR TEMP	6500K
BEAM ANGLE	55°
RATED LIFE	L80 50,000hrs
IP RATING	IP20
MATERIAL	Polycarbonate
WARRANTY	5 Years: full fitting and battery

PRODUCT CODE	PRODUCT DESCRIPTION
SE/4/M/WH/865	CQR LED Emergency Slimline Exit Box c/w Arrow Up Legend - White
SE/4/M/BK/865	CQR LED Emergency Slimline Exit Box c/w Arrow Up Legend - Black
SE/4/ST/WH/865	CQR LED Emergency Slimline Exit Box - SELF-TEST - c/w Arrow Up Legend - WHITE

ACCESSORY CODE	PRODUCT DESCRIPTION
SE/4/LEG/D	CQR Emergency Legend for Slim Exit Box, Arrow Down
SE/4/LEG/L	CQR Emergency Legend for Slim Exit Box, Arrow Left
SE/4/LEG/R	CQR Emergency Legend for Slim Exit Box, Arrow Right
BATTERY/18650/1500	CQR Replacement Battery Bulkhead Plus / Spot Downlight / Exit Box Slimline







PRODUCT DESCRIPTION

- 5 in 1 emergency exit sign
- Maintained & Non-maintained optionality as standard
- Includes arrow up legend
- Other legends available separately
- Wall and surface mount as standard
- Kits available for: recessed/flag & suspension mounting options
- LED indicator and test button
- Manual test and Self-test options available
- Available in white and black

PRODUCT SPECIFICATION

VOLTAGE	AC 220-240V
INPUT POWER	M = 3W, NM = 0.8W Emergency Mode = 0.8W
LUMEN OUTPUT (MAINS)	24lm
LUMEN OUTPUT (EMERGENCY)	23lm
VIEWING DISTANCE	30M
EMERGENCY DURATION	3 Hours
EMERGENCY POWER	0.8W
COLOUR TEMP	6500K
RATED LIFE	L70 50,000hrs
IP RATING	IP20
MATERIAL	Polycarbonate
WARRANTY	5 Years: full fitting and battery

PRODUCT CODE	PRODUCT DESCRIPTION
BL/310/M/BK/865	CQR LED Emergency Blade Exit Sign c/w Arrow Up Legend - Black
BL/310/M/WH/865	CQR LED Emergency Blade Exit Sign c/w Arrow Up Legend - White
BL/310/ST/WH/865	CQR LED Emergency Blade Exit Sign - SELF-TEST - c/w Arrow Up Legend - White

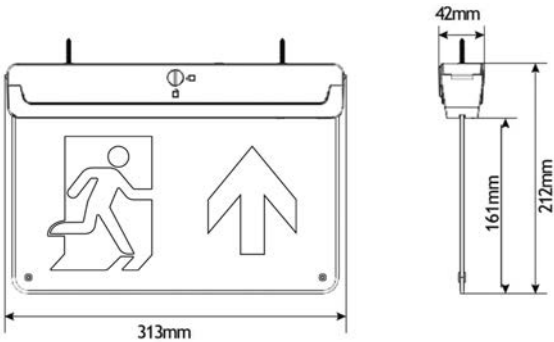

MULTI-FIX METHODS:

Wall and surface as standard  
Recessed/flag and suspension kits required\*

RECESSED  
BL/310/RECKIT/WH OR BK\*



WALL  
AS STANDARD



FLAG  
BL/310/FLAGKIT/WH OR BK\*



SURFACE  
AS STANDARD



SUSPENSION  
BL/310/SUSKIT/WH OR BK\*



ACCESSORY CODE	PRODUCT DESCRIPTION
BL/310/LEG/D	CQR Emergency Legend for Blade Exit Sign, Arrow Down
BL/310/LEG/LR	CQR Emergency Legend for Blade Exit Sign, Arrow Left/Right
BL/310/RECKIT/WH	CQR Emergency Recessed Kit for Blade Exit Sign - White
BL/310/SUSKIT/BK	CQR Emergency Suspended kit for BLADE Exit Sign - BLACK
BL/310/SUSKIT/WH	CQR Emergency Suspended kit for BLADE Exit Sign - WHITE
BL/310/FLAGKIT/WH	CQR Emergency Flag Mounting Kit for Blade Exit Sign
BATTERY/18650/1100	CQR Replacement Battery Exit Sign Blade 5 in 1





# Emergency Twin Spots



## EMERGENCY TWIN SPOTS - 500lm & 1000lm Versions



Scan the QR code to see the product spacing data

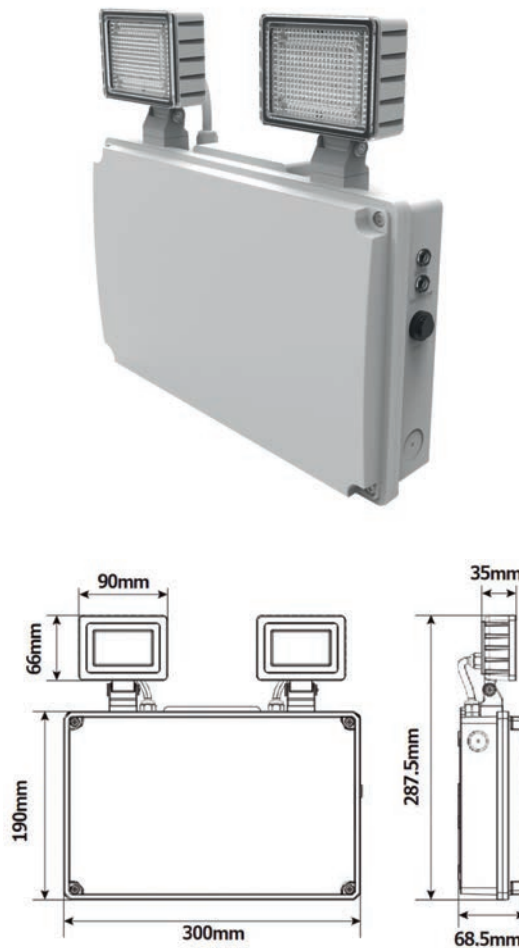

### PRODUCT DESCRIPTION

- Emergency Twin Spots: 500lm & 1000lm versions
- 1000lm output version suitable for larger areas
- Narrow or wide beam angle options
- Self-test function available
- Available in white and black

AVAILABLE IN BLACK FOR BOTH THE  
2 X 250lm & 2 X 500lm VERSIONS

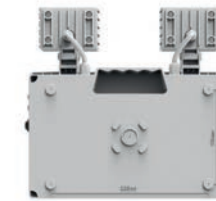

### PRODUCT SPECIFICATION

	TS/4: 2 x 250lm	TS/8: 2 x 500lm
VOLTAGE	AC 220-240V	AC 220-240V
INPUT POWER	2.2W (Charging mode) 4W (Discharge mode)	4.2W (Charging mode) 9W (Discharge mode)
LUMEN OUTPUT (MAINS)	500lm	1000lm
LUMEN OUTPUT (EMERGENCY)	540lm	1139lm
EMERGENCY DURATION	3 Hours	3 Hours
EMERGENCY POWER	2.2W (Charging Mode) 4W (Discharge Mode)	4.2W (Charging Mode) 9W (Discharge Mode)
COLOUR TEMP	6500K	6500K
RATED LIFE	L70 50,000hrs	L70 50,000hrs
IP RATING	IP65	IP65
MATERIAL	Polycarbonate	Polycarbonate
WARRANTY	5 Years: full fitting and battery	5 Years: full fitting and battery

PRODUCT CODE	PRODUCT DESCRIPTION
TS/4/NM/WH/865	CQR LED Emergency Twin Spot, 2 x 250lm, IP65 - White
TS/4/NM/BK/865	CQR LED Emergency Twin Spot, 2 x 250lm, IP65 - Black
TS/4/ST/WH/865	CQR LED Emergency Twin Spot - SELF-TEST - 2 x 250lm, IP65 - White
TS/8/NM/WH/865	CQR LED Emergency Twin Spot, 2 x 500lm, IP65 - White
TS/8/NM/BK/865	CQR LED Emergency Twin Spot, 2 x 500lm, IP65 - Black
TS/8/ST/WH/865	CQR LED Emergency Twin Spot - SELF-TEST - 2 x 500lm, IP65 - White

ACCESSORY CODE	PRODUCT DESCRIPTION
BATTERY/26650/6600	CQR Replacement Battery Twin Spots 2 x 250lm
BATTERY/26650/6600	CQR Replacement Battery Bulkhead Max / Twin Spots 2 x 500lm







**CUSTOMER SERVICE/  
TECH SUPPORT**

14-16 HOGHTON STREET,  
SOUTHPORT, MERSEYSIDE,  
PR9 0PA, UK

**ACCOUNTS TEAM**

110B WALSALL ROAD,  
CANNOCK, STAFFORDSHIRE,  
WS11 0JB, UK

**MANUFACTURING/  
DISTRIBUTION**

125 PASTURE ROAD,  
MORETON, WIRRAL,  
CH46 4TH, UK

MAIN: +44 (0)151 606 1000

INFO@CQR.CO.UK  
TECH@CQR.CO.UK

CQR.CO.UK



**DISTRIBUTED BY:**